

Screws

Stainless Steel, with Recessed Stud for Loss Protection, Hygienic Design

SPECIFICATION

Identification no.

No. **1**: Without additional lock washer

Stainless steel AISI 316L

- Matte finish (Ra < 0.8 µm) **MT**
- Polished finish (Ra < 0.8 µm) **PL**

Sealing ring

- H-NBR **H**
Temperature resistant -25 °C to +150 °C
- EPDM **E**
Temperature resistant -40 °C to +120 °C
- Blue
- Hardness 85±5 Shore A
- FDA compliant

INFORMATION

Screws GN 1582 with low-profile head are certified according to EHEDG guidelines and therefore ideal for use in hygienic areas. Due to the d₄ recessed stud, they are easily secured against loss, such as in a cover. Thus the „captivity of the mounting element“ according to the Machinery Directive 2006 / 42 / EG is given.

When using, instead of a typical tapped and bore hole, it is necessary to provide tapped bores with a thread d₁ on each of the two elements to be assembled. Additionally, a clearance bore of d₅ on one or both sides must be cut. Depending on the design and required clamping length a₁ ... a₃ of the component being attached, there are a number of assembly options as shown above. Alternatively, securing can also be achieved by an additional lock washer mounted on the thin shank d₄.

ACCESSORY

- Sealing Rings GN 7600 (see page)

ON REQUEST

- with FKM sealing ring (Fluorine rubber) **F**

TECHNICAL INFORMATION

- Plastic Characteristics (see page A2)
- Stainless Steel Characteristics (see page A26)



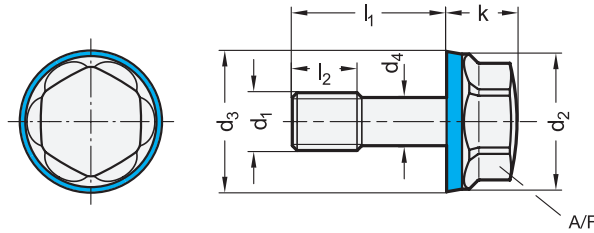

Assembly options

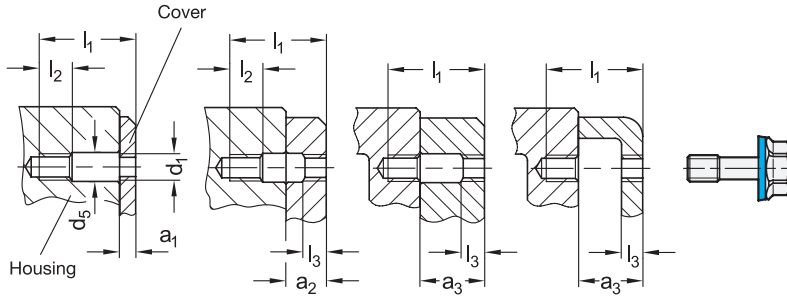

* Complete with type index of the Stainless Steel Screws

MT Matte PL Polished

GN 1582-H

STAINLESS STEEL

Description	d1	l1	a1	a2	a3	d2	d3	d4	d5	k	l2	l3	A/F	⚖
GN 1582-M5-20-*-H-1	M 5	20	2.5-6	6-10.5	10.5-14	11	11.8	4	5.5	7	6	2.5	8	5
GN 1582-M5-25-*-H-1	M 5	25	6-11	11-14	14-19	11	11.8	4	5.5	7	6	2.5	8	6
GN 1582-M6-25-*-H-1	M 6	25	3-7	7-13	13-17	13	13.8	4.8	6.5	7.5	8	3	10	9
GN 1582-M6-30-*-H-1	M 6	30	7-12	12-17	17-22	13	13.8	4.8	6.5	7.5	8	3	10	10
GN 1582-M8-30-*-H-1	M 8	30	4-8	8-16	16-20	16	16.8	6.5	8.5	8.5	10	4	13	18
GN 1582-M8-40-*-H-1	M 8	40	8-18	18-25	25-30	16	16.8	6.5	8.5	8.5	10	4	13	21
GN 1582-M10-40-*-H-1	M 10	40	5-14	14-19	19-28	19	19.8	8.2	10.5	9.5	12	5	16	34
GN 1582-M10-50-*-H-1	M 10	50	14-24	24-28	28-38	19	19.8	8.2	10.5	9.5	12	5	16	39

GN 1582-E

STAINLESS STEEL

Description	d1	l1	a1	a2	a3	d2	d3	d4	d5	k	l2	l3	A/F	⚖
GN 1582-M5-20-*-E-1	M 5	20	2.5-6	6-10.5	10.5-14	11	11.8	4	5.5	7	6	2.5	8	5
GN 1582-M5-25-*-E-1	M 5	25	6-11	11-14	14-19	11	11.8	4	5.5	7	6	2.5	8	6
GN 1582-M6-25-*-E-1	M 6	25	3-7	7-13	13-17	13	13.8	4.8	6.5	7.5	8	3	10	9
GN 1582-M6-30-*-E-1	M 6	30	7-12	12-17	17-22	13	13.8	4.8	6.5	7.5	8	3	10	10
GN 1582-M8-30-*-E-1	M 8	30	4-8	8-16	16-20	16	16.8	6.5	8.5	8.5	10	4	13	18
GN 1582-M8-40-*-E-1	M 8	40	8-18	18-25	25-30	16	16.8	6.5	8.5	8.5	10	4	13	21
GN 1582-M10-40-*-E-1	M 10	40	5-14	14-19	19-28	19	19.8	8.2	10.5	9.5	12	5	16	34
GN 1582-M10-50-*-E-1	M 10	50	14-24	24-28	28-38	19	19.8	8.2	10.5	9.5	12	5	16	39

Weight type MT

